

HEYFORD AVENUE

HEYFORD AVENUE

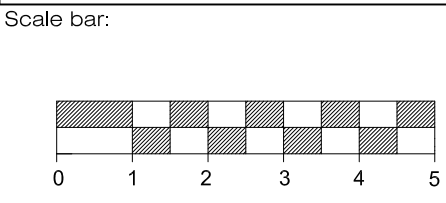

DRAWING NOTE:
 This drawing is not suitable for Construction. Local Authority Approvals will be required. Discharge of Conditions and details to be incorporated into this document after Council approval.
 All dimensions should be verified on site. Any discrepancies should be notified to the Architect. These drawings are subject to a full laser & topographical survey, as floor levels, heights and the structure, drainage, investigations etc. will alter the design and spatial arrangement. The proposal for this project will have floor & ceiling levels raised and lowered. This drawing should not be relied upon on site. This drawing has Arc 3's copyright. This project is subject to Party Wall matters, C.D.M Regulations, CIL Liability and 'Specialist Reports'.
 No encroachment of boundaries by the eaves, foundations and gutters. All materials to match existing.

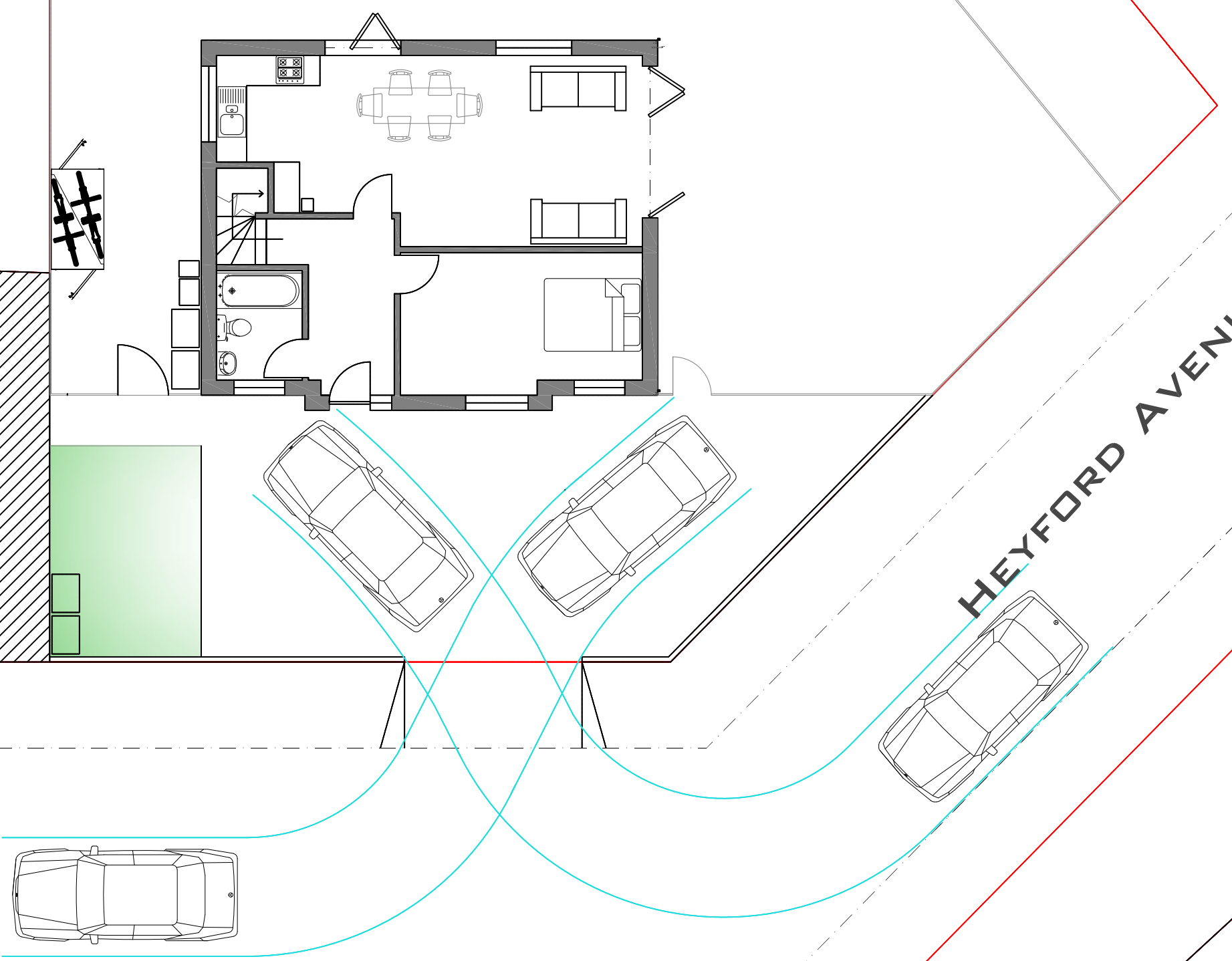

ARC 3 ARCHITECTURE
 103 STATION ROAD
 WEST WICKHAM
 KENT
 BR4 0PX
 TEL: 020 8777 4000
 E: info@arc3architecture.co.uk

Project: LAND@HEYFORD AVE.
 MERTON SW20 9JT

Notify architect for drawings and/or specification discrepancy.
 This project is subject to survey and statutory approvals.
 Copyright: this drawing must not be reproduced in whole or part without written consent. Do not scale from this drawing. Verify all dimensions on site.

Title: PROPOSED GROUND FLOOR PLAN (VEHICLES TRACKING DIAGRAM)	
Scale: 1:100 @ A3	Date: 27.08.2020
Drawn: WYU	Checked: MV
Project No.: G919	Drawing No.: 107
Revision:	

This page is intentionally left blank